



FIRE
RESISTANT
GLASSES

Pilkington PYRODUR



F I R E T E S T S U M M A R Y

Multi-pane Steel Screen
30 minutes integrity

Assessment Reference C 80773



PILKINGTON

Multi-pane Steel Screen

30 minutes integrity

Assessment Reference:

C80773

Test Station:

Warrington Fire Research Centre

Date:

1st July 1994

Sponsor:

Pilkington United Kingdom Limited

Test Standard:

BS 476: Part 22: 1987

Note:

If the non-fire rated glass incorporates a flammable interlayer, the Pilkington PYRODUR glass must be orientated towards the unexposed face.

General description of the assembly

- 10mm Pilkington PYRODUR glass
- Single glazing, or double glazed with non-fire rated glass
- Mild steel framework (insulated or non-insulated)
- Mild steel snap-on glazing beads
- Different methods of intumescent seal incorporated into the construction

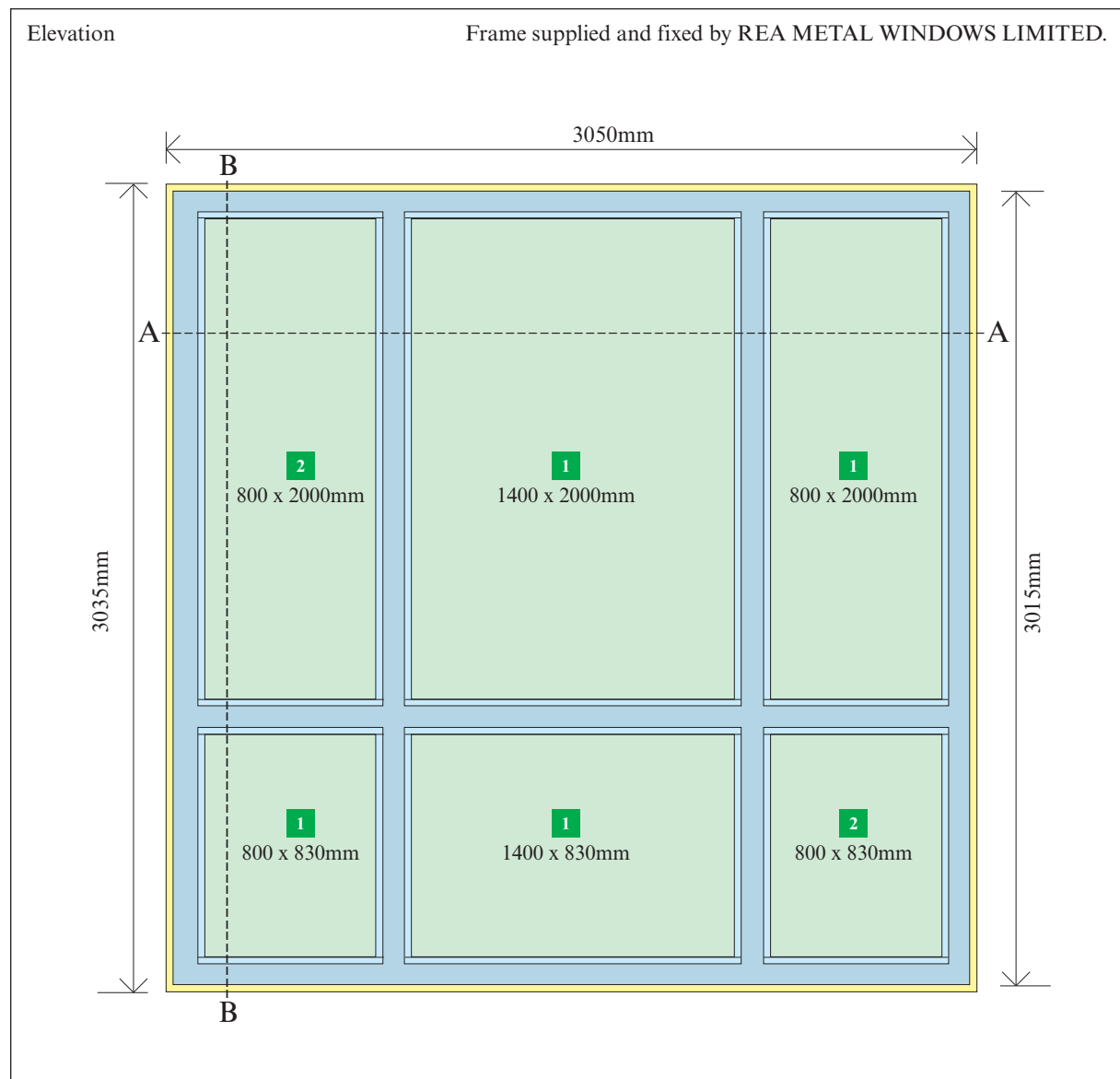

Glazing dimensions are actual glass sizes

Key to figures

- 1** 10mm Pilkington PYRODUR glass
- 2** Nominal 24mm double glazing unit (10mm Pilkington PYRODUR/8mm cavity/6mm secondary pane)
- 3** 55 x 25 x 1.8mm mild steel rolled hollow section
- 4** 55 x 25mm ETERNIT PROMAT Promatect insulation board
- 5** 15 x 25 x 1.25mm steel glazing beads
- 6** 20 x 25 x 1.25mm steel glazing beads
- 7** 25 x 25 x 1.25mm steel glazing beads
- 8** 5mm diameter steel studs at nominal 300mm centres
- 9** 5mm hardwood setting block
- 10** Proprietary glazing medium, either: LORIENT POLYPRODUCTS LTD. System 36/10 glazing gasket (for single glazing only)
CARBORUNDUM RESISTANT MATERIALS LTD. Fibrefrax ceramic tape
ADSHEAD RATCLIFFE & Co. LTD. F90 self-adhesive foam tape
DUFAYLITE DEVELOPMENTS LTD. Interdens intumescent seal
- 11** ADSHEAD RATCLIFFE & Co. LTD. Arbo 1070 fire resistant silicone
- 12** 64 x 3mm countersunk woodscrews
- 13** ROCKWOOL LTD. mineral fibre packing
- 14** ADSHEAD RATCLIFFE & Co. LTD. Arbo 1096 seal

For reasons of confidentiality some of the section sizes and fixing details have been omitted. Please contact the frame manufacturer for further information.

Section B—B

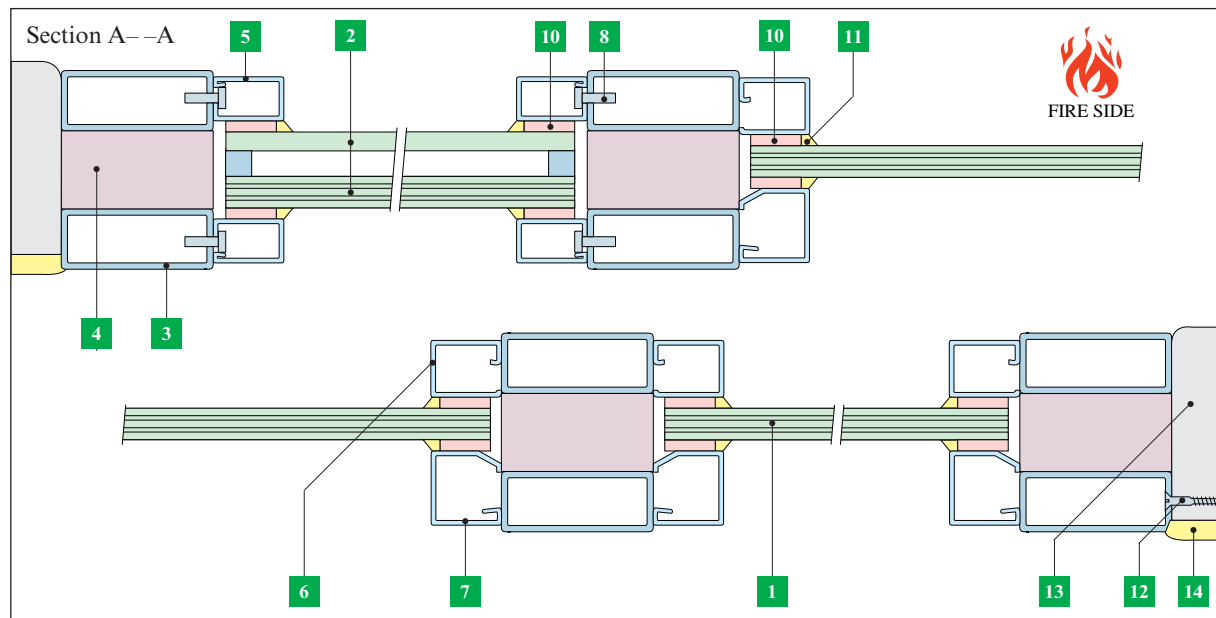
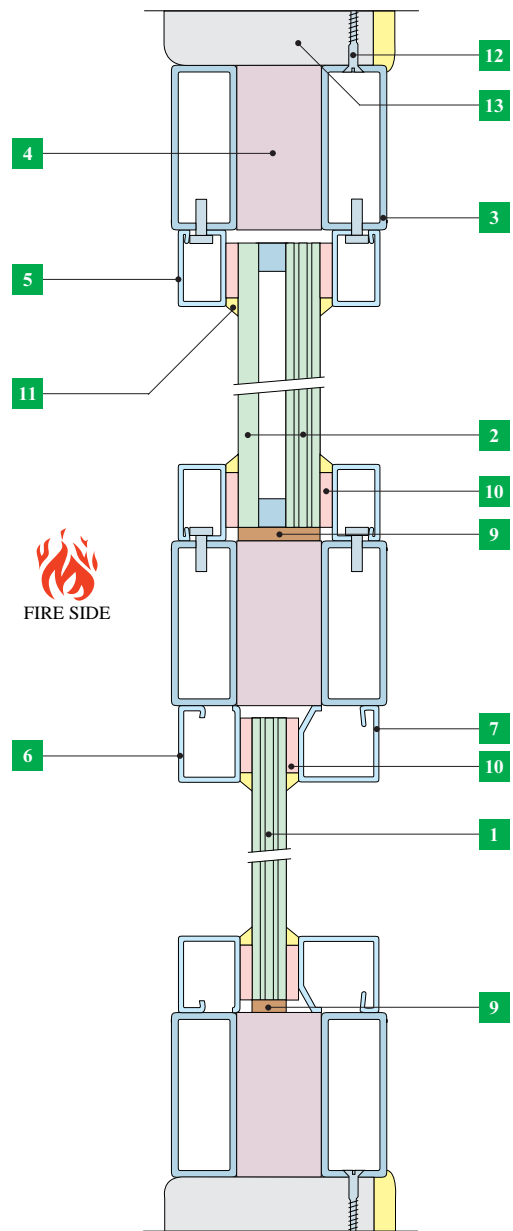

Scope

The results of this assessment only relate to the anticipated behaviour of the specimen of the element of construction under the particular conditions of the test. They are not intended to be the sole criteria for assessing the potential fire performance of the element in use nor do they reflect the actual behaviour in fires.

Pilkington PYRODUR glass is classified as a Class B safety glass according to the impact performance requirements of BS 6206:1981, and has been tested extensively in accordance with the fire test requirements of BS 476: Part 22: 1987.

This publication gives a general description of the product and materials. It is the responsibility of the user of this document to ensure that their use is appropriate for any particular application and that such application complies with all relevant local and national legislation, standards, codes of practice and other requirements.

Pilkington United Kingdom Limited hereby disclaim all liability howsoever arising from any error in or omission from this publication and for all consequences of relying on it.

All products shown in CAPITALS are trademarks of the Pilkington Group.



PILKINGTON

Pilkington United Kingdom Limited
Prescot Road St Helens England WA10 3TT
Telephone 01744 692000 Fax 01744 613049