

November/December 2014

## The topics covered in today's newsletter are:

- **A shining example**

- Pilkington **Profilit**™ OW low iron glass used for the new youth centre in Wigan, United Kingdom

- Pilkington **Profilit**™ Amethyst and -T Color H

- The extension to Vellesan College in the Netherlands

- **Profiled glass with system**

- New: now also available for the thermally broken frame profiles of the series 60 range - Pilkington **Profilit**™ dilatation profiles #820 D and #821 D for the Pilkington **Profilit**™ profiles #820 and #821

- **Energy efficiency and sustainability**

- New: the Environmental Product Declaration (EPD) for Pilkington **Profilit**™

- **Turn your façade into a communication space**

- New: Pilkington **Profilit**™ ProfiScreen

- Pilkington **Profilit**™ at the Glasstec 2014 fair

- In the area dedicated to Stuttgart University's "glass technology live" special show in hall 11 stand B42

- **A shining example**

- Pilkington **Profilit™** OW low iron glass used for the new youth centre in Wigan, UK

As the result of an architectural competition, the architects' office Austin-Smith:Lord was commissioned to plan the new youth centre "Wigan Youth Zone" in Wigan, United Kingdom. The plans featured the use of generously sized facades comprising low-iron Pilkington **Profilit™** OW in various design options.



Builder: Wigan City Council, Wigan, United Kingdom

Architect: Austin-Smith:Lord

Our customer: Westcrowns Contracting Services, Glasgow

The facades consist in part of double glazed applications with Pilkington **Profilit™** clear glass; in other areas double glazed Pilkington **Profilit™** was provided with translucent thermal insulation for the purpose of optimising the physical efficiency of the building envelope.

Together with the use of low-iron white glass, the design of the glazing without intermediate posts and with fully glazed corner elements additionally imbues the complex with a certain lightness.

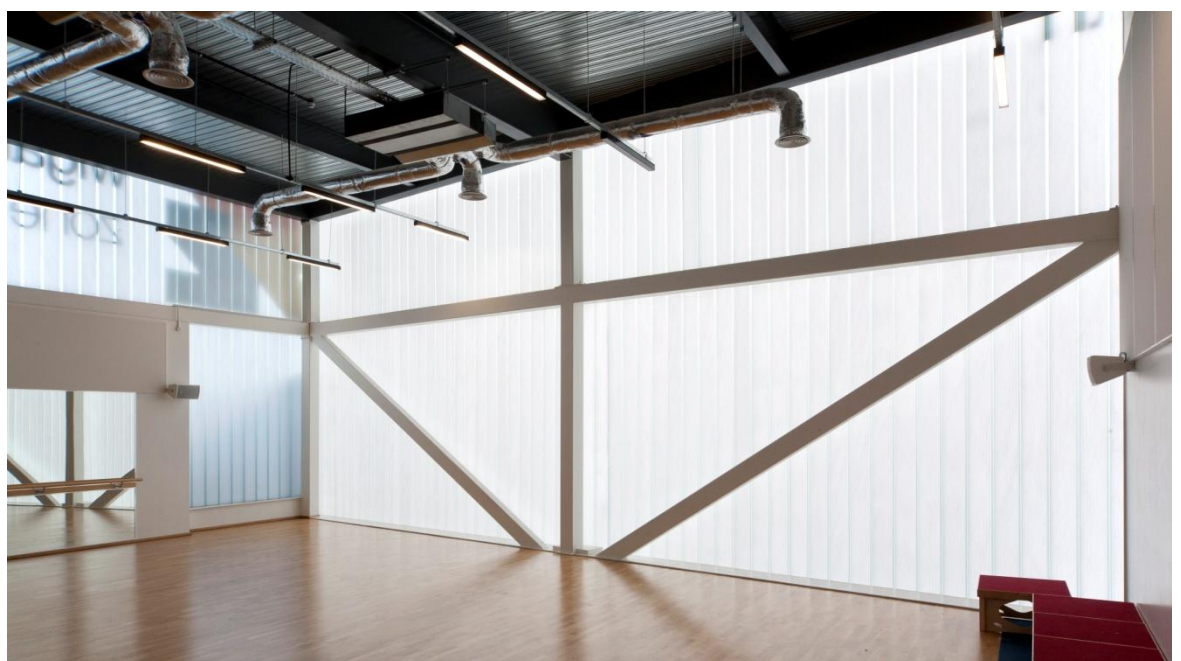

- Pilkington **Profilit™ Amethyst and -T Color H**

- The extension to Vellesan College in the Netherlands

The building complex of Vellesan College, which is a listed property, was extended back in 1980 and has now undergone further extension in the form of an additional wing. The extension encompasses approx. 1,200 m<sup>2</sup> floor space and in terms of architecture and colouring harmonises well with the historic main building.



Builder: Vellesan College

Architect: Angela Holterman van  
Holland Zicht te Amsterdam

Photographer: AWE Krijger

Our customer: Glasimpex Schiedam  
B.V.

Around 1,000 m<sup>2</sup> Pilkington **Profilit**<sup>™</sup> in the design options Amethyst, Clear and colourfully enamelled Pilkington **Profilit**<sup>™</sup> T Color H were used for the extension.

The installation type applied here was double glazed and in part with translucent thermal insulation in the cavity between the glass panels, whereby the use of Pilkington **Profilit**<sup>™</sup> in various degrees of translucency combined with clear glass elements made of Pilkington Insulight is particularly attractive.

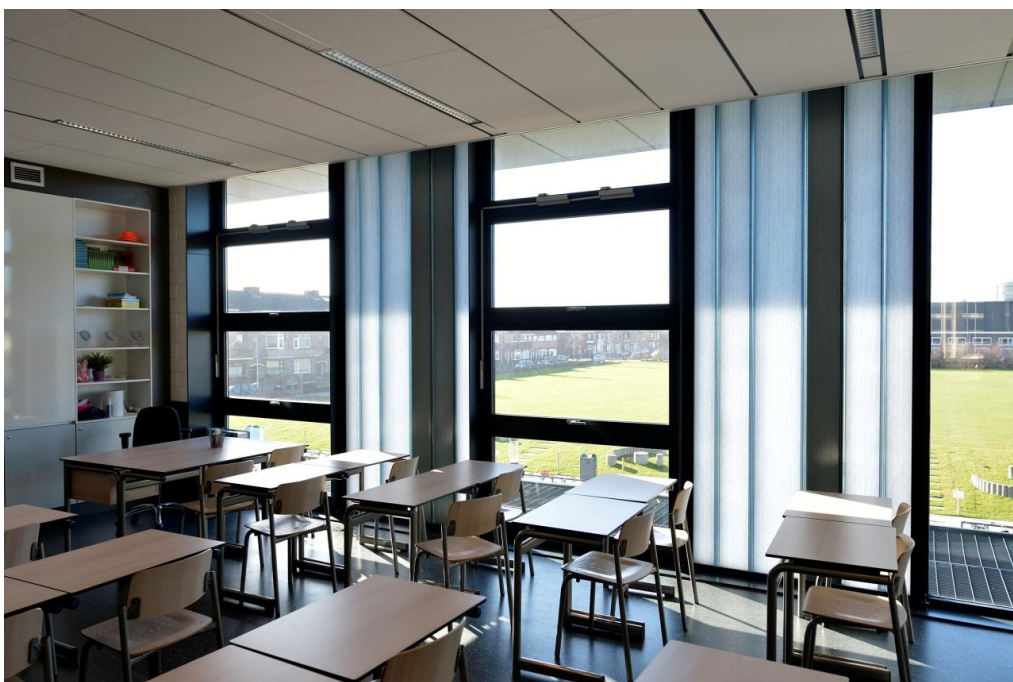
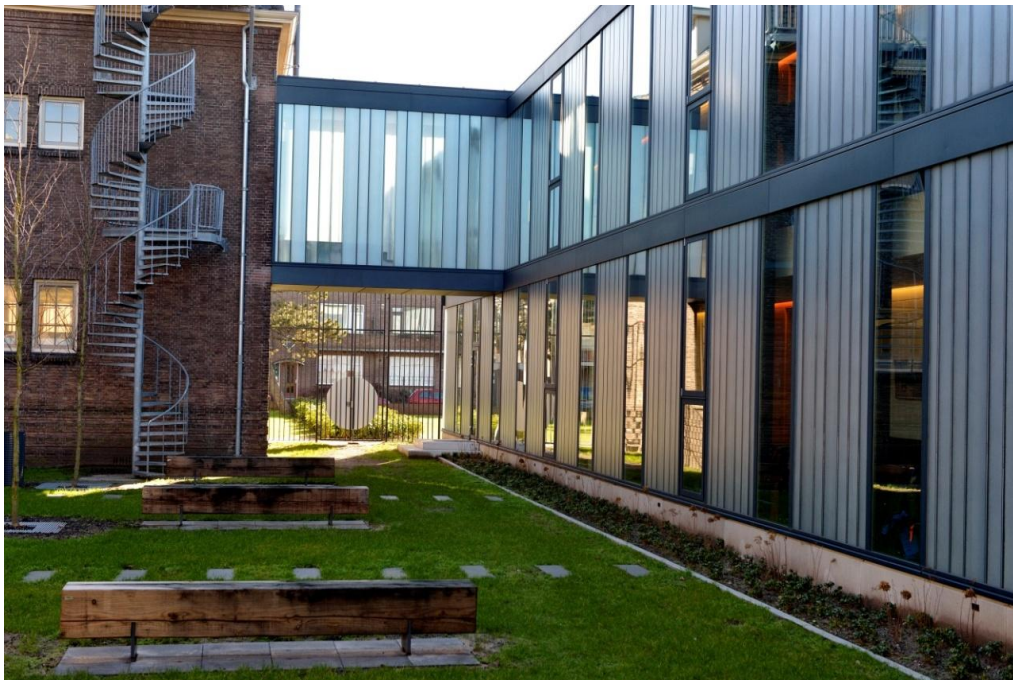

- **Profiled glass with system**

- Innovation: now also available for the thermally broken frame profiles of the series 60 range - Pilkington **Profilit™** dilatation profiles #820 D and #821 D for the Pilkington **Profilit™** profiles #820 and #821

In May 2014 we informed you about the new connection profiles for the thermally isolated Pilkington **Profilit™** frames #810 (top / side) and #811 or #811/xx (bottom, with or without a window sill). These were very well received by both architects and customers and already incorporated into the planning of Pilkington **Profilit™** façades. The positive resonance prompted us to quickly develop the corresponding profiles for the thermally isolated series 60 frames too. The expansion joint connectors #820 D and #821 D are available with immediate effect for use in conjunction with #820, #821 and #821/XX frames.

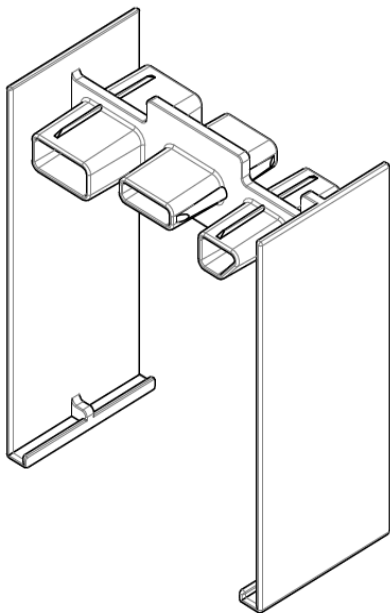

Fig 1: Pilkington **Profilit™** profile #820 D

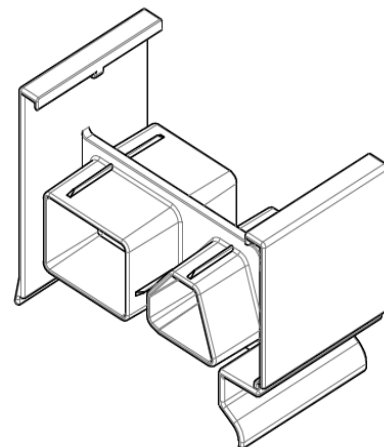

Fig 2: Pilkington **Profilit™** profile #821 D

The new Pilkington **Profilit™** system components simplify frame installation, notably in respect of the flush mounting of system components, the formation of expansion joints and the sealing of longitudinal joints,

whereby a particularly practical feature is that the expansion joint profile # 821 D can be used both for the thermally isolated frame #821 without window sill as well as for the options with moulded or mounted window sills.

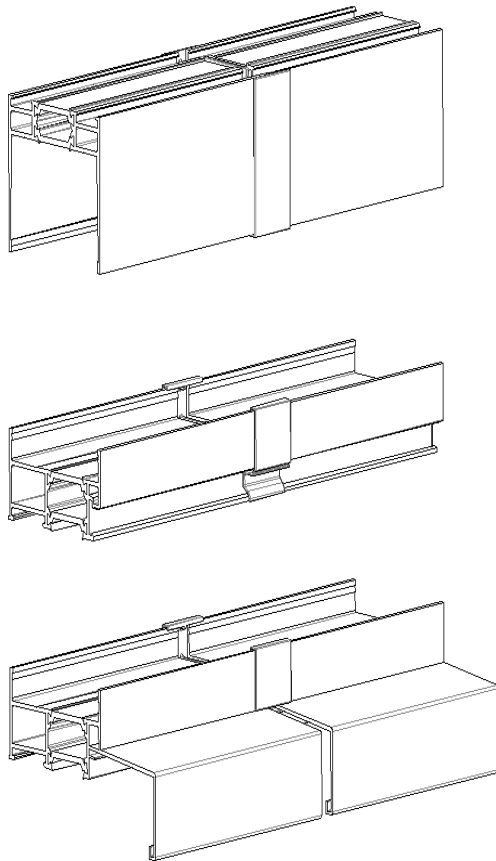

Fig 3: Usage of #820 D and #821 D profiles

The expansion joint connectors are initially available as a light-grey full-colour option. Enquiries for design options with paint-compatible finishes can however also be placed with us if required

We would be pleased to provide you with further information on the application of the new system components, texts for invitations to tender as well as on prices and packaging units on request.

## • Energy efficiency and sustainability

- Innovation: the environmental product declaration (EPD) for Pilkington **Profilit™**

Construction with sustainable building materials and products is a prerequisite increasingly expected by investors and architects in the planning of buildings.

In order to simplify the use of Pilkington **Profilit™** for such buildings as are to be certified in accordance with LEED, DGNB or BREEAM standards, for example, we have drawn up an EPD (**E**nvironmental **P**roduct **D**eclaration) for Pilkington **Profilit™** products and had it certified by Institut Bauen und Umwelt e.V. (IBU).



The environmental product declaration was drawn up in accordance with the standards ISO 14025 and EN 15804 and is available with immediate effect for building certification as and when required.

- **Turn your façade into a communication space**

- New: Pilkington **Profilit™** ProfiScreen

With Pilkington **Profilit™** ProfiScreen you can use your façade in full or in part as a communication space.

View by day:



View by night:



Further information on Pilkington **Profilit™** ProfiScreen can be obtained on request.

- Pilkington **Profilit™** at the **Glasstec 2014 fair**

- In the area dedicated to Stuttgart University's "glass technology live" special show in hall 11B42

This year too you could again inform yourself about the latest product and system developments relevant to Pilkington **Profilit™** in the area of the Glasstec fair in Düsseldorf dedicated to Stuttgart University's "glass technology live" special show. The focus this year was on the further optimisation of the physical performance of the system. As such, depending on the choice of the Pilkington **Profilit™** system and product combination concerned e.g. in terms of thermal insulation,  $U_G$  levels of down to  $0.85 \text{ W/m}^2\text{K}$  can be reached.

Kindly contact our Application Technology department with any questions you may have on the topics covered in this newsletter.

Yours sincerely

**Bauglasindustrie GmbH**

Hüttenstraße 33

D - 66839 Schmelz/Saar

Tel. +49 (0) 6887 303 0

Fax +49 (0) 6887 303 45